



American University Campus Plan 2021



American University





What Is a Campus Plan?

- The campus planning process is distinctly unique in Washington, D.C. due to the small urban environment with many residential neighborhoods. Every ten years or so, all colleges and universities must submit a campus plan before the District's Zoning Commission.
- A campus plan is a roadmap for the projected facilities growth and campus enhancements for the next decade. The intent of the process is to promote well planned and designed campuses; to encourage long term facilities planning; and to minimize the negative impacts on surrounding residential areas.
- American University's [2011 Campus Plan](#) was approved by the Zoning Commission on March 8, 2012. It reflected AU's intent to strengthen its academic prestige, maintain our standing as an asset to Washington, DC, and honor a commitment to be an amenity to the surrounding community. AU is in the process of creating our 2021 campus and we welcome feedback from neighbors, faculty, staff, and students.
- In an effort to be inclusive and transparent in this process, we have created the AU Neighborhood Partnership ("The Partnership"). The Partnership is a collection of neighborhood residents and AU staff that are working together to discuss all the issues so that we can draft and file a consensus-based campus plan that meets AU's needs for the future while limiting the objectionable impacts on the neighborhood.

Campus Plan Elements

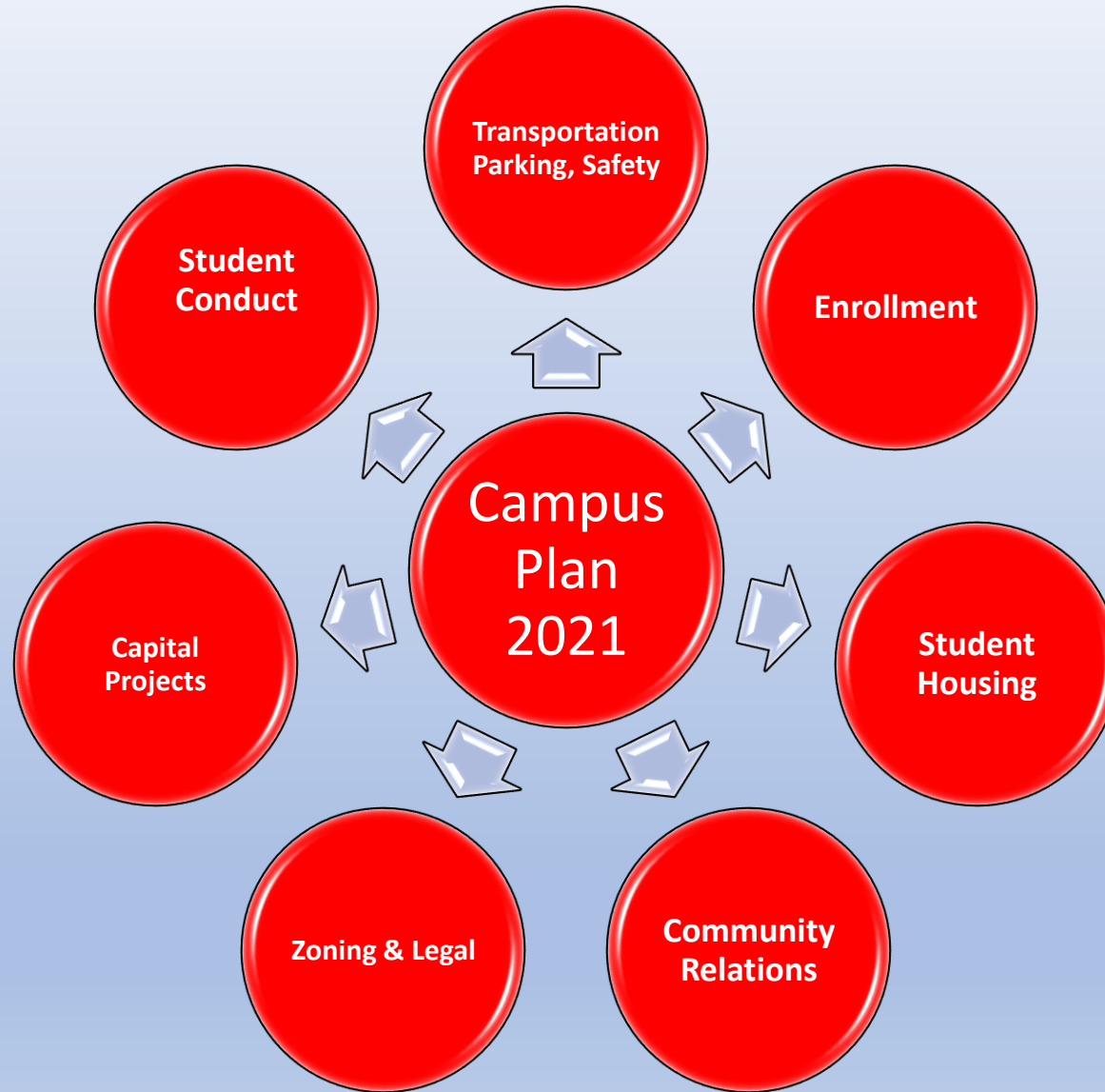

American University

OPPORTUNITY SITE LOCATIONS

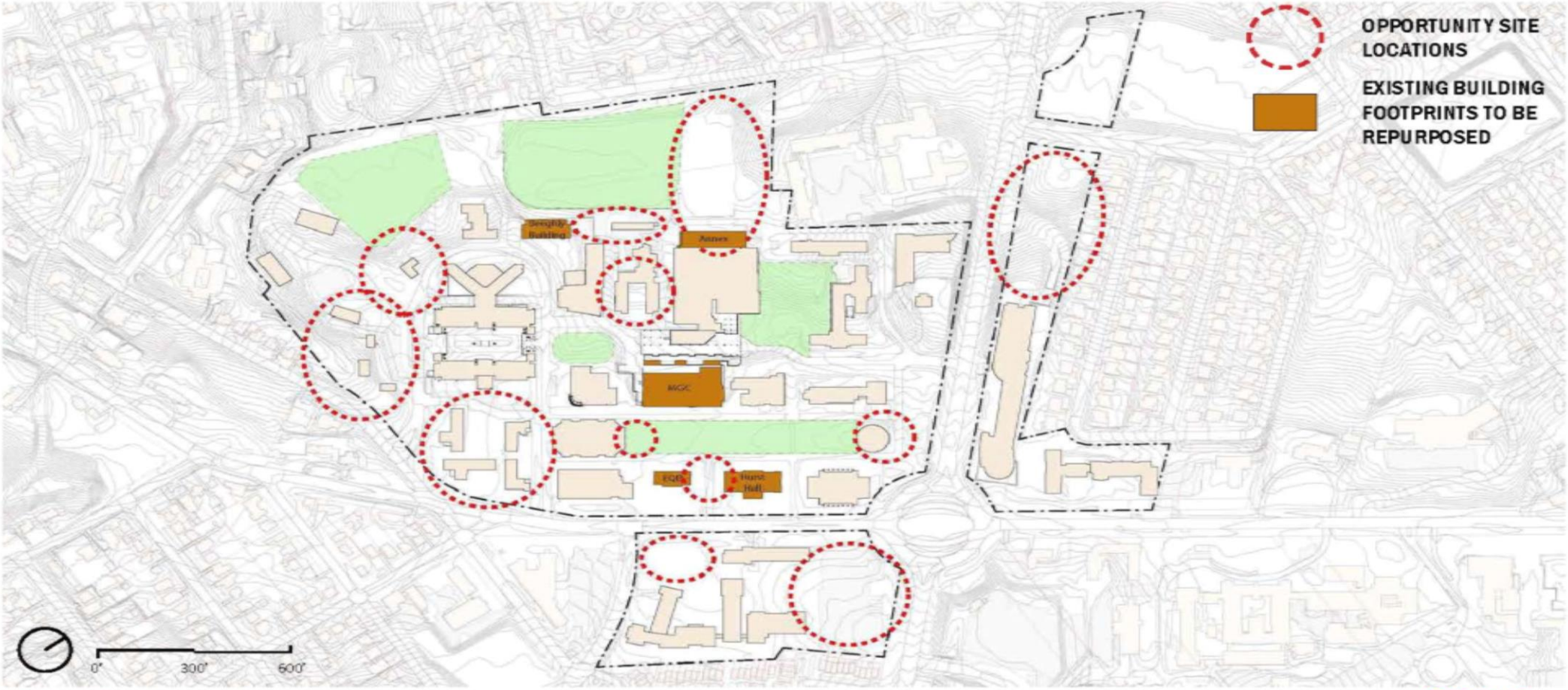



AMERICAN UNIVERSITY

W A S H I N G T O N , D C

For more information about the 2021 Campus Plan:

Ed Fisher – AVP, Community & Government Relations

edfisher@american.edu

202.885.2167

Maria Barry – Director, Community Relations

mariab@american.edu

202.885.2146

Campus Plan Page:

<https://www.american.edu/finance/ppm/campus-plan.cfm>

Community Relations Page:

<https://www.american.edu/communityrelations/>